

REVISIONS				
ZONE	REV	DESCRIPTION	DATE	APPROVED

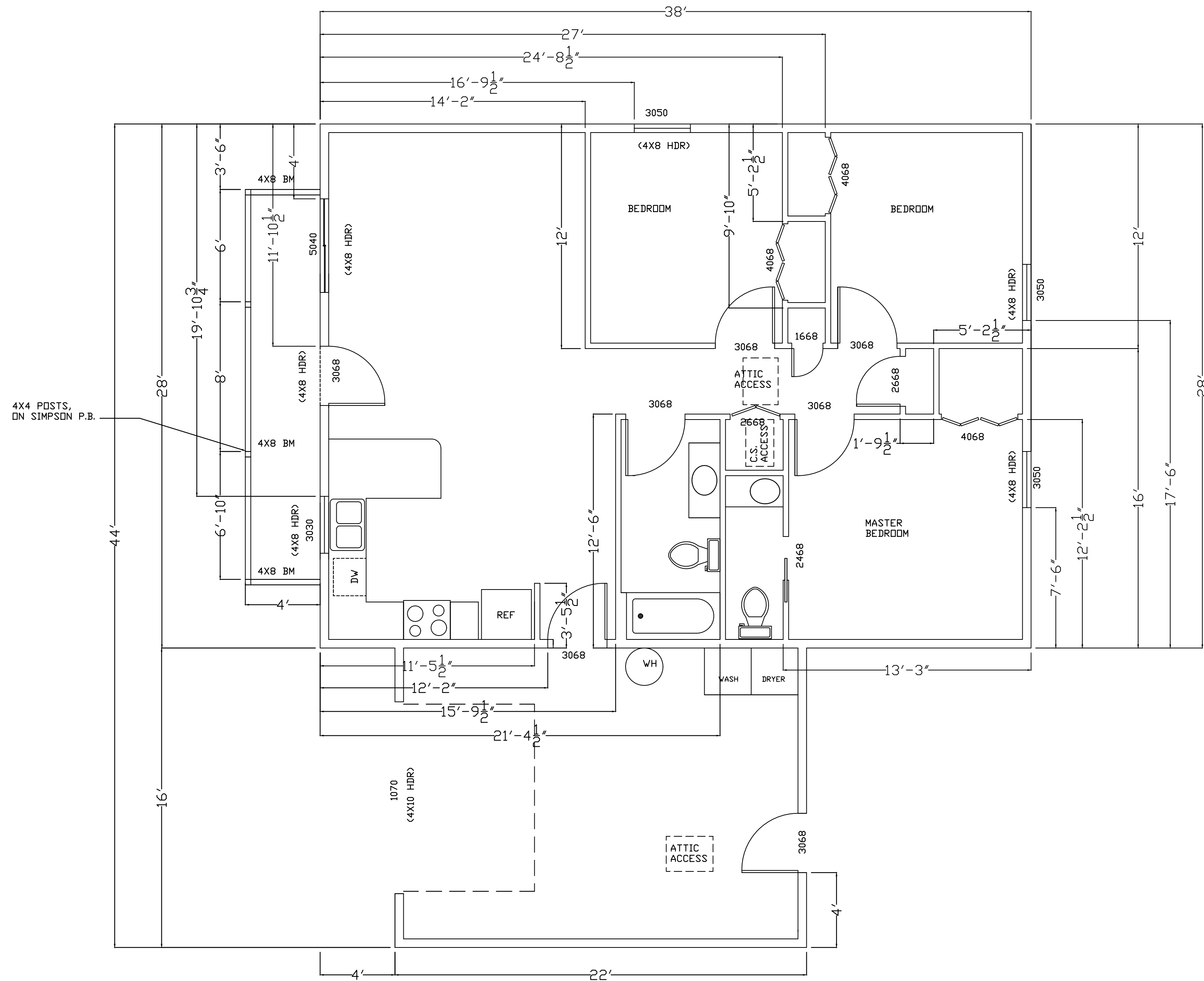

LIVING AREA 1064 SQ FT

NOTE:
 1. EGRESS WINDOWS MAX 44' OFF FINISHED FLOOR
 2. SEISMIC STRAPPING TO BE PROVIDED FOR WATER HEATER

FLOOR PLAN				
740 TERRITORIAL ST, HARRISBURG, OR				
	SIZE	FSCM NO.	DWG NO.	REV
	C			
REV 12/15/2018	SCALE 1/4" = 1'		SHEET 3 OF 7	